



Contact characteristics

| | | |
|--|---------|-------|
| IEC Conventional free air thermal current $I_{th} \leq 40^\circ\text{C}$ | A | 30 |
| IEC Conventional free air thermal current $I_{th} \leq 65^\circ\text{C}$ | A | 30 |
| Rated insulation voltage U_i IEC/EN | V | 1000 |
| Rated impulse withstand voltage U_{imp} | kV | 8 |
| Reactive power for control of capacitors at | | |
| Conditional short-circuit current (rms) | kA | 200 |
| Short-circuit protection with fuse | Class/A | J/30 |
| Mechanical life | cycles | 10000 |

Mechanical features

| | | | |
|---------------------------------|---------------|---------------|------|
| Fixing | Screw | | |
| Terminals | type | Hex terminals | |
| | width | mm | 25 |
| Tightening torque for terminals | max | Nm | 2 |
| | max | lbin | 17.7 |
| Conductor section | AWG/kcmil min | 10 | |
| | AWG/kcmil max | kcmil | 2 |
| Weight | | g | 1500 |

UL technical data

| | | | |
|--|------|---------|--------|
| UL Standard | UL98 | | |
| General purpose current rating | A | 30 | |
| Operating voltage max | V | 600 | |
| Horsepower/FLA current three phase motor | 240V | HP/A | 7.5/22 |
| | 480V | HP/A | 15/21 |
| | 600V | HP/A | 20/22 |
| Short circuit rating | | kA rms | 200 |
| Short circuit rating with fuse | | Class/A | J/30 |

Ambient conditions

| | | | |
|-----------------------|-----|------------------|------|
| Operating temperature | min | $^\circ\text{C}$ | -25 |
| | max | $^\circ\text{C}$ | 55 |
| Storage temperature | min | $^\circ\text{C}$ | -40 |
| | max | $^\circ\text{C}$ | 70 |
| Max altitude | | m | 3000 |

Resistance & Protection

| | |
|---------------------|------|
| Frontal IP degree | IP20 |
| Terminals IP degree | IP20 |
| Pollution degree | 3 |

Dimensions

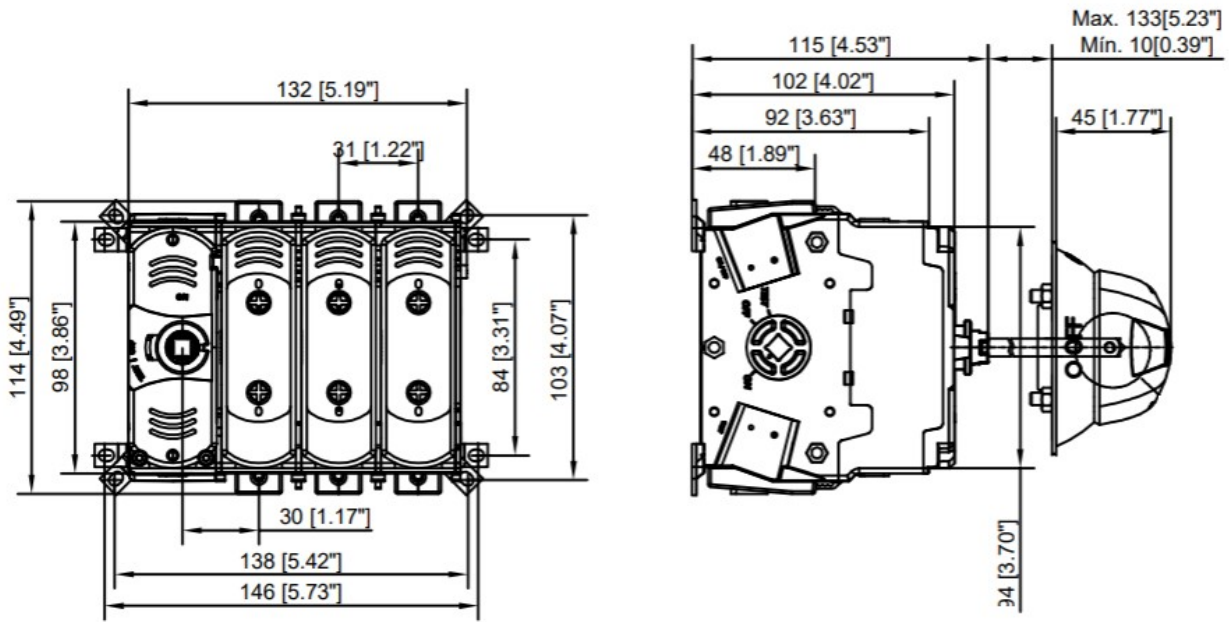

Wiring diagrams

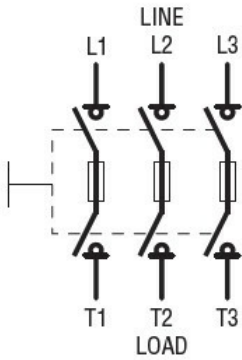

Certifications and compliance

Compliance

IEC/EN/BS 60947-1

IEC/EN/BS 60947-3

Certifications

cULus according to UL98 / CSA C22.2 n°4

ETIM classification

ETIM 8.0

EC000216 -
Switch
disconnecter