



Product designation	Changeover Switch		
Product type designation	GA		
Number of poles	Nr.	4	
Operating voltage type		AC	
<b>Contact characteristics</b>			
IEC Conventional free air thermal current I <sub>th</sub>	A	40	
Rated insulation voltage U <sub>i</sub> IEC/EN	V	1000	
Rated impulse withstand voltage U <sub>imp</sub>	kV	8	
Operating current I <sub>e</sub>			
AC21A			
	400V	A	40
	500V	A	40
	690V	A	40
AC22A			
	400V	A	40
	500V	A	40
	690V	A	40
AC23A			
	400V	A	40
	500V	A	25
	690V	A	25
Power dissipation per pole max	W	1	
Rated operational power AC23A			
	400V	kW	18.5
	690V	kW	22
Conditional short-circuit current (rms)	kA	10	
Short-circuit protection with fuse	Class/A	gG40	
Making capacity AC23A 400V	A	400	
Breaking capacity AC23A 400V	A	320	
Mechanical life	cycles	100000	
Electrical life AC21A	cycles	100000	
<b>Mechanical features</b>			
Operating position	normal allowable	Vertical plan Any	
Fixing		Screw / DIN rail 35mm	
Terminals			
	type	Pillar	
	width	mm	5.6
	height	mm	6.5
	screw	M4	
	tool	Phillips 2	
Tightening torque for terminals			

min	Nm	1.8
max	Nm	2
min	Ibin	16
max	Ibin	18

Conductor section

IEC min	mm <sup>2</sup>	0.75
IEC max	mm <sup>2</sup>	16
AWG/kcmil min		18
AWG/kcmil max		6

Weight

g	1250
---	------

Ambient conditions

Operating temperature

min	°C	-25
max	°C	+55

Storage temperature

min	°C	-40
max	°C	+70

Max altitude

m	3000
---	------

Resistance & Protection

Frontal IP degree

IP20

Pollution degree

3

Dimensions

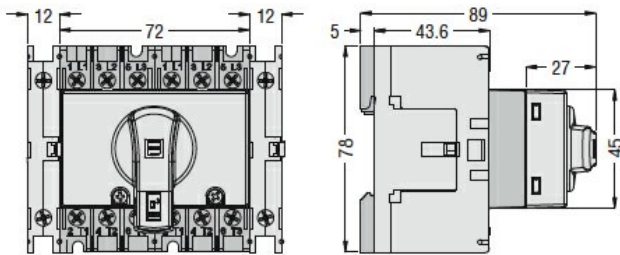

Wiring diagrams

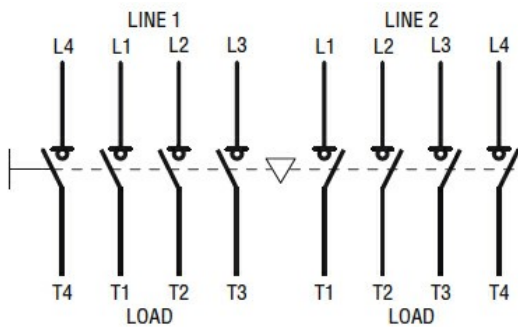

ETIM classification

ETIM 8.0

EC000216 -  
Switch  
disconnecter