



Product designation

Changeover  
Switch

Product type designation

GA

Number of poles

Nr.

4

Operating voltage type

AC

**Contact characteristics**

IEC Conventional free air thermal current I<sub>th</sub>

A

25

Rated insulation voltage U<sub>i</sub> IEC/EN

V

1000

Rated impulse withstand voltage U<sub>imp</sub>

kV

8

Operating current I<sub>e</sub>

AC21A

400V

A

25

500V

A

25

690V

A

25

AC22A

400V

A

25

500V

A

25

690V

A

25

AC23A

400V

A

25

500V

A

25

690V

A

25

Power dissipation per pole max

W

0.4

Rated operational power AC23A

400V

kW

11

690V

kW

22

Conditional short-circuit current (rms)

kA

10

Short-circuit protection with fuse

Class/A

gG25

Making capacity AC23A 400V

A

400

Breaking capacity AC23A 400V

A

320

Mechanical life

cycles

100000

Electrical life AC21A

cycles

100000

**Mechanical features**

Operating position

normal  
allowable

Vertical plan  
Any

Fixing

Screw / DIN rail  
35mm

Terminals

type  
width  
height  
screw  
tool

mm  
mm

Pillar  
5.6  
6.5  
M4  
Phillips 2

Tightening torque for terminals

min	Nm	1.8
max	Nm	2
min	Ibin	16
max	Ibin	18

Conductor section

IEC min	mm <sup>2</sup>	0.75
IEC max	mm <sup>2</sup>	16
AWG/kcmil min		18
AWG/kcmil max		6

Weight

g	1250
---	------

Ambient conditions

Operating temperature

min	°C	-25
max	°C	+55

Storage temperature

min	°C	-40
max	°C	+70

Max altitude

m	3000
---	------

Resistance & Protection

Frontal IP degree

IP20

Pollution degree

3

Dimensions

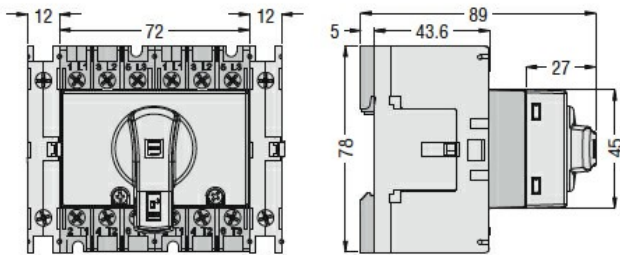

Wiring diagrams

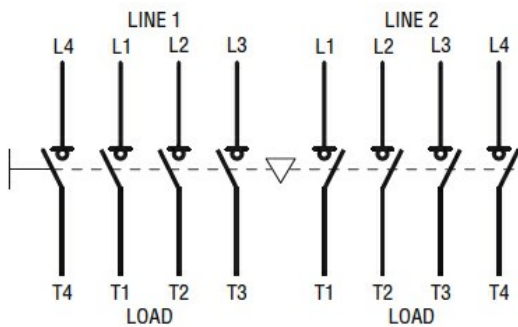

ETIM classification

ETIM 8.0

EC000216 -  
Switch  
disconnecter