



Soft starter
advanced
ADXNP
Asynchronous
three phase

Product designation

Product type designation

Motor type

Electrical features

Supplies voltage

Type of system		Three phase
Rated supply voltage	V	208...600VAC
auxiliary supply voltage (Us)		24VAC/DC
Rated frequency	Hz	50/60
Rated starter current Ie	A	25

Rated motor power

IEC ratings (T≤40°C)

230VAC	kW	5.5
400VAC	kW	11
500VAC	KW	15

UL ratings (T≤40°C)

220-240VAC	HP	7.5
380-415VAC	HP	10
440-480VAC	HP	15
550-600VAC	HP	20

Number of controlled phases

Nr. 2

Built-in bypass

Yes

Cooling System

Natural or forced
(optional)

Rated insulation voltage Ui

V 600

Programming interface

Potentiometer

Settings: starting
voltage,
acceleration
ramp,
deceleration
ramp. Note.
Potentiometers
can be disabled
via NFC.

Display

No

Programming with NFC technology

Yes

Optical port

Yes

Startup and stop settings

Startup method

Voltage ramp with
current limit

Stop method

Voltage ramp or
free-wheel stop

Acceleration ramp

s 1-20

Deceleration ramp

s 0-20

Startup voltage	%	30-80
Protections		
Power supply Protection		No power line, phase loss, frequency out of limits, minimum and maximum voltage and phase sequence
Motor protection		Electronic current thermal protection (overload), locked rotor, current asymmetry, load too low, starting too long
Starter protection		Overtemperature and overcurrent
Functions		
Built-in bypass		2
Built-in display and keypad		Yes
Languages		No
View measurements		No
Torque control		No
Adjustable current limit		No
Dynamic braking		Yes
Kick Start function		No
Motor overload electronic protection		Yes
Motor protection PTC input		Yes
Protection against phase loss		No
Protection against phase inversion		Yes
Protection against locked rotor		Yes
Protection against thyristor overtemperature		Yes
Protection against low load		Yes
Programmable alarm		Yes
Digital inputs		Yes
Analog inputs		Yes
Digital outputs		No
Analog output		Yes
Monitoring communication		No
Optical port for programming		Optional
Event log		Yes
Motor hour counter		No
Startup counter		Yes
Clock calendar		Yes
Remote external keypad		No
Plug-in version		No
Input and Output		
Digital inputs	Number of digital input Digital input type Digital input functions	Nr. 1 Volt-free contact Motor start

Digital outputs

Number of digital output	Nr.	2
Digital output arrangement		2 NO contacts with the same common, 5A 250VAC AC1 - 5A 30 VDC
Digital output functions		Programmable: line contactor (Run), TOR (Top Of Ramp), alarm, max torque

Communication interfaces

Communication interface

NFC, optical port for the connection of USB (CX01) and Wi-Fi (CX02) devices, optional RS485 module (CX04) Modbus RTU protocol

Ambient conditions

Temperature

Operating temperature

min	°C	-20
max	°C	+60°C (with current derating >40°C)

Storage temperature

min	°C	-30
max	°C	+80

Max altitude

m 1000 without derating of the starter current

Relative humidity

% <80%

Pollution degree

2

Installation category

III

Housing

Mounting

Screw-fixing or 35mm DIN rail (IEC/EN/BS 60715)

IP degree of protection

IP20

Dimensions (W x H x D)

mm 45 x 159 x 128.4

Weight

Kg 0.66

Dimensions

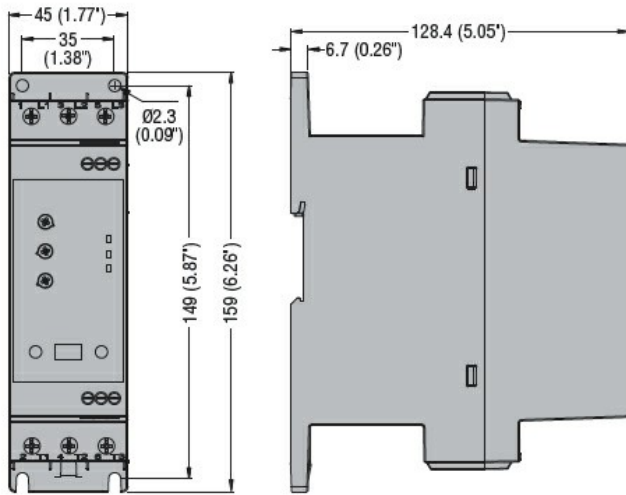

Certifications and compliance

Compliance

CSA C22.2 n° 60947-4-2

IEC/EN/BS 60947-1

IEC/EN/BS 60947-4-2

UL 60947-4-2

Certificates

cULus

EAC

RCM (pending)

ETIM classification

ETIM 8.0

EC000640 - Soft starter