

|   |                   |     |      |   |
|---|-------------------|-----|------|---|
| Product designation                                       |                   |     |      | Enclosed rotary cam switch              |
| Product type designation                                  |                   |     |      | GX40                                    |
| <b>General characteristics</b>                            |                   |     |      |   |
| Switching diagram   |                   |     |      | 05 - ON/OFF switch 1 pole               |
| N° of elements  |                   |     |      | 1                                       |
| Mounting form   |                   |     |      | P - Plastic enclosure with black handle |
| <b>Contact characteristics</b>                            |                   |     |      |   |
| Rated insulation voltage $U_i$                            | IEC/EN            | V   | 690  |   |
|   | UL/CSA            | V   | 600  |   |
| Rated impulse withstand voltage $U_{imp}$                 |                   |     | kV   | 6                                       |
| Conventional free air thermal current $I_{th}$            | IEC/EN            | A   | 40   |   |
|   | UL/CSA            | A   | 40   |   |
| Rated operational voltage                                 |                   |     | V    | 440                                     |
| Rated operational impulse voltage                         |                   |     | kV   | 4                                       |
| Maximum fuse size for short-circuit protection $I_n$ (gG) | 10kA              | A   | 40   |   |
|   | 15kA              | A   | 35   |   |
|   | 25kA              | A   | 35   |   |
| Rated short time current $I_{cw}$                         |                   |     | 1s   | kA                                      |
|   |                   |     |      | 1000                                    |
| Conductivity  |                   |     |      | 10/5 mA/V                               |
| Operational current $I_e$ IEC/EN                          | AC1/AC21A         |     |      | A                                       |
|   |                   |     |      | 40                                      |
| AC15  | 110V              | A   | 25   |   |
|   | 220/230V          | A   | 22   |   |
|   | 380/400V          | A   | 12   |   |
|   | 660/690V          | A   | 2    |   |
|   |                   |     |      |   |
| Rated operational power in AC                             | Three-phase AC-3  |     |      |   |
|   | 220/230V          | kW  | 7.5  |   |
|   | 380/440V          | kW  | 15   |   |
|   | 500/690V          | kW  | 15   |   |
|   | Single-phase AC-3 |     |      |   |
|   | 110V              | kW  | 2.2  |   |
|   | 220/230V          | kW  | 4.4  |   |
|   | 380/440V          | kW  | 7    |   |
|   | Three-phase AC23A |     |      |   |
|   | 220/230V          | kW  | 9    |   |
|   | 380/440V          | kW  | 18.5 |   |
|   | 500/690V          | kW  | 15   |   |
| Single-phase AC23A  |                   |     |      |   |
| 110V  | kW                | 3   |      |   |
| 220/230V  | kW                | 5.2 |      |   |
| 380/440V  | kW                | 7.5 |      |   |
| Rated operational current in DC                           |                   |     |      |   |

|  |      |                 |                   |    |
|--|------|-----------------|-------------------|----|
| DC21A                                  |      |                 |                   |    |
|  | 48V  | A               | 40                |    |
|  | 60V  | A               | 40                |    |
|  | 110V | A               | 6                 |    |
|  | 220V | A               | 0.8               |    |
|  | 440V | A               | 0.25              |    |
| DC23A (poles in series)                |      |                 |                   |    |
|  | 24V  | A               | 40 (1)            |    |
|  | 48V  | A               | 40 (1)            |    |
|  | 60V  | A               | 40 (3)            |    |
|  | 110V | A               | 40 (3)            |    |
|  | 220V | A               | 12 (4)            |    |
| DC13                                   |      |                 |                   |    |
|  | 24V  | A               | 40                |    |
|  | 48V  | A               | 32                |    |
|  | 60V  | A               | 16                |    |
|  | 110V | A               | 3                 |    |
|  | 220V | A               | 0.5               |    |
|  | 440V | A               | 0.15              |    |
| Power dissipation                      |      | W               | 1.6               |    |
| <b>Mechanical features</b>             |      |                 |                   |    |
| Terminals screw                        |      |                 |                   | M4 |
| Tightening torque for terminals max    |      | Nm              | 1.2               |    |
| Conductor size                         |      |                 |                   |    |
| AWG - Rigid cable                      |      |                 |                   |    |
|  | min  | AWG             | 16                |    |
|  | Max  | AWG             | 8                 |    |
| AWG - Flexible cable                   |      |                 |                   |    |
|  | min  | AWG             | 16                |    |
|  | Max  | AWG             | 10                |    |
| Conductor size (IEC) - Flexible cable  |      |                 |                   |    |
|  | min  | mm <sup>2</sup> | 1.5               |    |
|  | Max  | mm <sup>2</sup> | 6                 |    |
| Conductor size (IEC) - Rigid cable     |      |                 |                   |    |
|  | min  | mm <sup>2</sup> | 1.5               |    |
|  | Max  | mm <sup>2</sup> | 10                |    |
| Mechanical life                        |      | cycles          | 1X10 <sup>6</sup> |    |
| <b>UL technical data</b>               |      |                 |                   |    |
| Motor power for direct-on-line control |      |                 |                   |    |
| for three-phase motor                  |      |                 |                   |    |
|  | 120V | HP              | 5                 |    |
|  | 240V | HP              | 10                |    |
|  | 480V | HP              | 15                |    |
|  | 600V | HP              | 15                |    |
| for single-phase motor                 |      |                 |                   |    |
|  | 120V | HP              | 2                 |    |
|  | 240V | HP              | 5                 |    |
| <b>Ambient conditions</b>              |      |                 |                   |    |
| Temperature                            |      |                 |                   |    |
| Operating temperature                  |      |                 |                   |    |
|  | min  | °C              | -25               |    |
|  | max  | °C              | +55               |    |
| Storage temperature                    |      |                 |                   |    |
|  | min  | °C              | -40               |    |

max °C +70

**Resistance & Protection**

|                     |      |
|---------------------|------|
| Frontal IP degree   | IP65 |
| Terminals IP degree | IP20 |

**Dimensions**

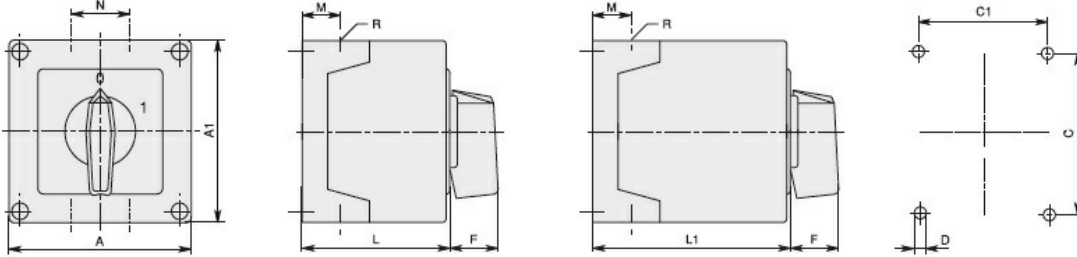

|      |         |     |     |     |     |      |    |     |    |    |      |      |       |        |      |
|------|---------|-----|-----|-----|-----|------|----|-----|----|----|------|------|-------|--------|------|
| GX16 | 90x90   | 1-2 | 3-5 | 90  | 90  | 79   | 79 | 4.5 | 25 | 19 | 30   | 71.3 | 98.3  | 4xPG16 | IP65 |
| GX20 |         | 1-2 | 3-5 |     |     |      |    |     |    |    |      |      |       |        |      |
| GX16 | 110x110 | 1-3 | 4-7 | 110 | 110 | 98.4 | 83 | 4.5 | 32 | 21 | 39.5 | 85.5 | 119.5 | 4xPG21 | IP65 |
| GX20 |         | 1-3 | 4-7 |     |     |      |    |     |    |    |      |      |       |        |      |
| GX32 |         | 1-2 | 3-4 |     |     |      |    |     |    |    |      |      |       |        |      |
| GX40 |         | 1-2 | 3-4 |     |     |      |    |     |    |    |      |      |       |        |      |

**Wiring diagrams**

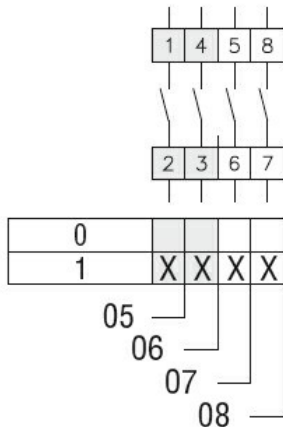

**Certifications and compliance**

**Compliance**

- IEC/EN/BS 60947-1
- IEC/EN/BS 60947-3
- IEC/EN/BS 60947-5-1
- IEC/EN/BS 61058-1

**Certificates**

EAC

**ETIM classification**

ETIM 8.0

EC001029 -  
Selector switch,  
complete