

|   |                   |      |      |  |
|---|-------------------|------|------|--|
| Product designation                                       |                   |      |      | Rotary cam switches  |
| Product type designation                                  |                   |      |      | GX20   |
| <b>General characteristics</b>                            |                   |      |      |  |
| Switching diagram   |                   |      |      | 07 - ON/OFF switch 3 poles   |
| N° of elements  |                   |      |      | 2  |
| Mounting form   |                   |      |      | O88 - Rear mounting with red/yellow handle padlockable in 0, door coupling and protection covers |
| <b>Contact characteristics</b>                            |                   |      |      |  |
| Rated insulation voltage $U_i$                            | IEC/EN            | V    | 690  |  |
|   | UL/CSA            | V    | 600  |  |
| Rated impulse withstand voltage $U_{imp}$                 |                   |      | kV   | 6  |
| Conventional free air thermal current $I_{th}$            | IEC/EN            | A    | 20   |  |
|   | UL/CSA            | A    | 15   |  |
| Rated operational voltage                                 |                   |      | V    | 440  |
| Rated operational impulse voltage                         |                   |      | kV   | 4  |
| Maximum fuse size for short-circuit protection $I_n$ (gG) | 10kA              | A    | 20   |  |
|   | 15kA              | A    | 20   |  |
|   | 25kA              | A    | 20   |  |
| Rated short time current $I_{cw}$                         |                   |      | 1s   | kA   |
|   |                   |      |      | 250  |
| Conductivity  |                   |      |      | 10/5 mA/V  |
| Operational current $I_e$ IEC/EN                          | AC1/AC21A         |      | A    | 20   |
|   | AC15              |      |      |  |
|   | 110V              | A    | 10   |  |
|   | 220/230V          | A    | 8    |  |
|   | 380/400V          | A    | 6    |  |
|   | 660/690V          | A    | 1.5  |  |
| Rated operational power in AC                             | Three-phase AC-3  |      |      |  |
|   | 220/230V          | kW   | 3.7  |  |
|   | 380/440V          | kW   | 5.5  |  |
|   | 500/690V          | kW   | 5.5  |  |
|   | Single-phase AC-3 |      |      |  |
|   | 110V              | kW   | 0.75 |  |
|   | 220/230V          | kW   | 1.8  |  |
|   | 380/440V          | kW   | 3    |  |
|   | Three-phase AC23A |      |      |  |
|   | 220/230V          | kW   | 4    |  |
|   | 380/440V          | kW   | 7.5  |  |
|   | 500/690V          | kW   | 7.5  |  |
| Single-phase AC23A  |                   |      |      |  |
| 110V  | kW                | 0.75 |      |  |

|   |          |                 |                   |
|---|----------|-----------------|-------------------|
|   | 220/230V | kW              | 2.2               |
|   | 380/440V | kW              | 3.5               |
| <b>Rated operational current in DC</b>        |          |                 |                   |
| DC21A   |          |                 |                   |
|   | 48V      | A               | 20                |
|   | 60V      | A               | 20                |
|   | 110V     | A               | 4                 |
|   | 220V     | A               | 0.6               |
|   | 440V     | A               | 0.25              |
| <b>DC23A (poles in series)</b>                |          |                 |                   |
|   | 24V      | A               | 20 (1)            |
|   | 48V      | A               | 20 (2)            |
|   | 60V      | A               | 20 (3)            |
|   | 110V     | A               | 10 (3)            |
|   | 220V     | A               | 8 (4)             |
| <b>DC13</b>                                   |          |                 |                   |
|   | 24V      | A               | 20                |
|   | 48V      | A               | 16                |
|   | 60V      | A               | 12                |
|   | 110V     | A               | 1                 |
|   | 220V     | A               | 0.4               |
|   | 440V     | A               | 0.15              |
| <b>Power dissipation</b>                      |          | W               | 0.6               |
| <b>Mechanical features</b>                    |          |                 |                   |
| <b>Terminals screw</b>                        |          |                 | M3                |
| <b>Tightening torque for terminals max</b>    |          | Nm              | 0.8               |
| <b>Conductor size</b>                         |          |                 |                   |
| AWG - Rigid cable                             |          |                 |                   |
|   | min      | AWG             | 20                |
|   | Max      | AWG             | 12                |
| AWG - Flexible cable                          |          |                 |                   |
|   | min      | AWG             | 20                |
|   | Max      | AWG             | 12                |
| Conductor size (IEC) - Flexible cable         |          |                 |                   |
|   | min      | mm <sup>2</sup> | 0.5               |
|   | Max      | mm <sup>2</sup> | 2.5               |
| Conductor size (IEC) - Rigid cable            |          |                 |                   |
|   | min      | mm <sup>2</sup> | 0.5               |
|   | Max      | mm <sup>2</sup> | 2.5               |
| <b>Mechanical life</b>                        |          | cycles          | 1X10 <sup>6</sup> |
| <b>UL technical data</b>                      |          |                 |                   |
| <b>Motor power for direct-on-line control</b> |          |                 |                   |
| for three-phase motor                         |          |                 |                   |
|   | 120V     | HP              | 1.5               |
|   | 240V     | HP              | 3                 |
|   | 480V     | HP              | 5                 |
|   | 600V     | HP              | 5                 |
| for single-phase motor                        |          |                 |                   |
|   | 120V     | HP              | 0.75              |
|   | 240V     | HP              | 1.5               |
| <b>Ambient conditions</b>                     |          |                 |                   |
| <b>Temperature</b>                            |          |                 |                   |
| Operating temperature                         |          |                 |                   |
|   | min      | °C              | -25               |

|                     |     |    |     |
|---------------------|-----|----|-----|
| Storage temperature | max | °C | +55 |
|                     | min | °C | -40 |
|                     | max | °C | +70 |

**Resistance & Protection**

|                     |      |
|---------------------|------|
| Frontal IP degree   | IP65 |
| Terminals IP degree | IP20 |

**Dimensions**

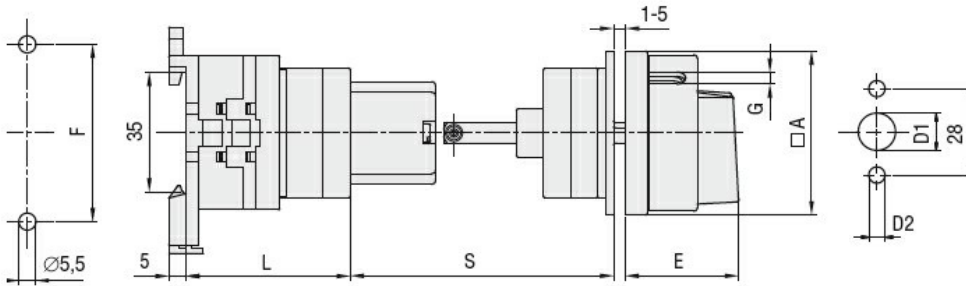

| Series      | Dimensions |    |    |      |    |    |   |       | L  |      |        |       |
|-------------|------------|----|----|------|----|----|---|-------|----|------|--------|-------|
|             | □A         | D1 | D2 | E    | F  | □K | G | S     | 1  | 2    | 3...12 |       |
| <b>GX16</b> | 48         | 12 | 5  | 34.2 | 52 | 36 | 5 | 45-55 | 40 | 48.5 | 57     | 133.5 |
| <b>GX20</b> | 48         | 12 | 5  | 34.2 | 52 | 36 | 5 | 45-55 | 40 | 48.5 | 57     | 133.5 |
| <b>GX32</b> | 65         | 14 | 5  | 38   | 68 | 48 | 6 | 45-55 | 51 | 63   | 75     | 183   |
| <b>GX40</b> | 65         | 14 | 5  | 38   | 68 | 48 | 6 | 45-55 | 51 | 63   | 75     | 183   |

**Wiring diagrams**

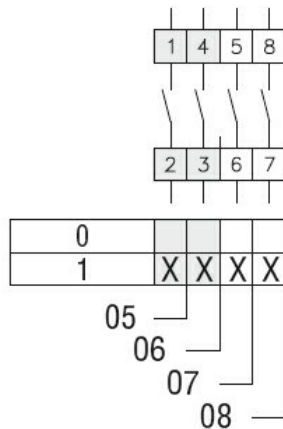

**Certifications and compliance**

Compliance

|                     |
|---------------------|
| CSA C22.2 n° 14     |
| IEC/EN/BS 60947-1   |
| IEC/EN/BS 60947-3   |
| IEC/EN/BS 60947-5-1 |
| IEC/EN/BS 61058-1   |
| UL60947-4-1         |

Certificates

|       |
|-------|
| cULus |
| EAC   |

**ETIM classification**

ETIM 8.0

EC001029 -  
Selector switch,  
complete