

Product designation				Rotary cam switches	
Product type designation				GX16	
<b>General characteristics</b>					
Switching diagram				110 - Multi-step 0-1-2-3-4-5 1 pole	
N° of elements				3	
Mounting form				U - Front mounting with black handle	
<b>Contact characteristics</b>					
Rated insulation voltage $U_i$	IEC/EN	V	690		
	UL/CSA	V	600		
Rated impulse withstand voltage $U_{imp}$			kV	6	
Conventional free air thermal current $I_{th}$	IEC/EN	A	16		
	UL/CSA	A	12		
			V	440	
Rated operational voltage			kV	4	
Maximum fuse size for short-circuit protection $I_n$ (gG)	10kA	A	16		
	15kA	A	16		
	25kA	A	16		
			1s	kA	250
Rated short time current $I_{cw}$				10/5 mA/V	
Conductivity					
Operational current $I_e$ IEC/EN	AC1/AC21A			A	16
	AC15				
		110V	A	10	
		220/230V	A	8	
		380/400V	A	4	
		660/690V	A	1.5	
	<b>Rated operational power in AC</b>				
Three-phase AC-3	220/230V	kW	3.5		
	380/440V	kW	4.5		
	500/690V	kW	5.5		
Single-phase AC-3	110V	kW	0.55		
	220/230V	kW	1.5		
	380/440V	kW	2.2		
Three-phase AC23A	220/230V	kW	3.7		
	380/440V	kW	6.5		
	500/690V	kW	7.5		
Single-phase AC23A	110V	kW	0.75		
	220/230V	kW	1.8		
	380/440V	kW	3		
<b>Rated operational current in DC</b>					

DC21A				
	48V	A		16
	60V	A		16
	110V	A		4
	220V	A		0.6
	440V	A		0.25
DC23A (poles in series)				
	24V	A		16 (1)
	48V	A		16 (2)
	60V	A		16 (3)
	110V	A		10 (3)
	220V	A		7 (4)
DC13				
	24V	A		16
	48V	A		14
	60V	A		10
	110V	A		1
	220V	A		0.4
	440V	A		0.15
Power dissipation		W		0.6
<b>Mechanical features</b>				
Terminals screw				3M
Tightening torque for terminals max		Nm		0.5
Conductor size				
AWG - Rigid cable				
	min	AWG		20
	Max	AWG		12
AWG - Flexible cable				
	min	AWG		20
	Max	AWG		12
Conductor size (IEC) - Flexible cable				
	min	mm <sup>2</sup>		0.5
	Max	mm <sup>2</sup>		2.5
Conductor size (IEC) - Rigid cable				
	min	mm <sup>2</sup>		0.5
	Max	mm <sup>2</sup>		2.5
Mechanical life		cycles		1X10 <sup>6</sup>
<b>UL technical data</b>				
Motor power for direct-on-line control				
for three-phase motor				
	120V	HP		1.5
	240V	HP		3
	480V	HP		5
	600V	HP		5
for single-phase motor				
	120V	HP		0.75
	240V	HP		1
<b>Ambient conditions</b>				
Temperature				
Operating temperature				
	min	°C		-25
	max	°C		+55
Storage temperature				
	min	°C		-40

max °C +70

**Resistance & Protection**

Frontal IP degree	IP65
Terminals IP degree	IP20

**Dimensions**

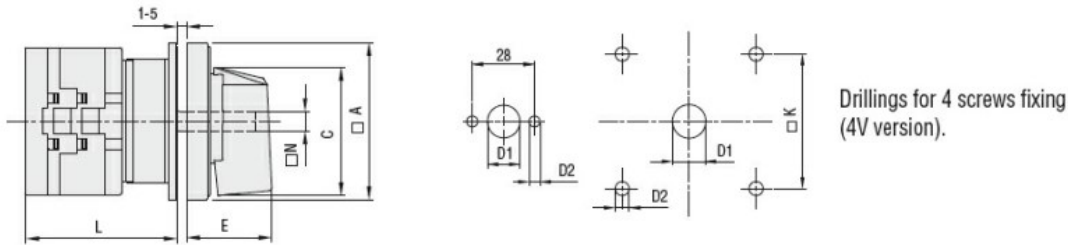

Series	Dimensions							L Number of elements											
	□A	C	∅D1	∅D2	E	□K	□N	1	2	3	4	5	6	7	8	9	10	11	12
GX16	48	39.5	12	5	26.5	36	6	43	51.5	60	68.5	77	85.5	94	102.5	111	119.5	128	136.5
GX20	48	39.5	12	5	26.5	36	6	43	51.5	60	68.5	77	85.5	94	102.5	111	119.5	128	136.5
GX32	65	53	14	5	34.5	48	7	51	63	75	85	99	111	123	135	147	159	171	183
GX40	65	53	14	5	34.5	48	7	51	63	75	85	99	111	123	135	147	159	171	183

**Wiring diagrams**

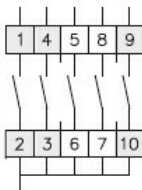

0					
1	X				
2			X		
3					X
4		X			
5				X	

110

**Certifications and compliance**

**Compliance**

- CSA C22.2 n° 14
- IEC/EN/BS 60947-1
- IEC/EN/BS 60947-3
- IEC/EN/BS 60947-5-1
- IEC/EN/BS 61058-1
- UL60947-4-1

**Certificates**

- cULus
- EAC

**ETIM classification**

ETIM 8.0

EC001029 -  
Selector switch,  
complete