



Product designation

Rotary cam  
switches

Product type designation

GF20

**General characteristics**

Switching diagram

91 - ON/OFF  
switch 2 poles

N° of elements

1

Mounting form

U25 - Front  
mounting with  
red/yellow handle  
padlockable in 0  
and protection  
covers

**Contact characteristics**

Rated insulation voltage  $U_i$

|        |   |     |
|--------|---|-----|
| IEC/EN | V | 480 |
| UL/CSA | V | 240 |

Rated impulse withstand voltage  $U_{imp}$

|    |   |
|----|---|
| kV | 4 |
|----|---|

Conventional free air thermal current  $I_{th}$

|        |   |    |
|--------|---|----|
| IEC/EN | A | 20 |
| UL/CSA | A | 15 |

Rated operational voltage

|   |     |
|---|-----|
| V | 480 |
|---|-----|

Rated operational impulse voltage

|    |   |
|----|---|
| kV | 4 |
|----|---|

Maximum fuse size for short-circuit protection  $I_n$  (gG)

|      |   |    |
|------|---|----|
| 10kA | A | 20 |
| 15kA | A | 20 |
| 25kA | A | 20 |

Rated short time current  $I_{cw}$

|    |    |     |
|----|----|-----|
| 1s | kA | 250 |
|----|----|-----|

Conductivity

10/5 mA/V

Operational current  $I_e$  IEC/EN

AC1/AC21A

|   |    |
|---|----|
| A | 20 |
|---|----|

AC15

|          |   |    |
|----------|---|----|
| 110V     | A | 10 |
| 220/230V | A | 8  |
| 380/400V | A | 6  |

Rated operational power in AC

Three-phase AC-3

|          |    |   |
|----------|----|---|
| 220/230V | kW | 3 |
| 380/440V | kW | 5 |

Single-phase AC-3

|          |    |     |
|----------|----|-----|
| 110V     | kW | 0.5 |
| 220/230V | kW | 1.5 |
| 380/440V | kW | 2   |

Three-phase AC23A

|  |          |                 |                   |
|--|----------|-----------------|-------------------|
|  | 220/230V | kW              | 4                 |
|  | 380/440V | kW              | 7.5               |
| Single-phase AC23A                     |          |                 |                   |
|  | 110V     | kW              | 0.75              |
|  | 220/230V | kW              | 2                 |
|  | 380/440V | kW              | 2.5               |
| Rated operational current in DC        |          |                 |                   |
| DC21A                                  |          |                 |                   |
|  | 48V      | A               | 20                |
|  | 60V      | A               | 20                |
|  | 110V     | A               | 4                 |
|  | 220V     | A               | 0.7               |
|  | 440V     | A               | 0.2               |
| DC13                                   |          |                 |                   |
|  | 24V      | A               | 6                 |
|  | 48V      | A               | 6                 |
|  | 60V      | A               | 3                 |
|  | 110V     | A               | 1                 |
|  | 220V     | A               | 0.4               |
|  | 440V     | A               | 0.15              |
| Power dissipation                      |          | W               | 0.8               |
| <b>Mechanical features</b>             |          |                 |                   |
| Terminals screw                        |          |                 | M3                |
| Tightening torque for terminals max    |          | Nm              | 0.5               |
| Conductor size                         |          |                 |                   |
| AWG - Rigid cable                      |          |                 |                   |
|  | min      | AWG             | 20                |
|  | Max      | AWG             | 12                |
| AWG - Flexible cable                   |          |                 |                   |
|  | min      | AWG             | 20                |
|  | Max      | AWG             | 12                |
| Conductor size (IEC) - Flexible cable  |          |                 |                   |
|  | min      | mm <sup>2</sup> | 0.5               |
|  | Max      | mm <sup>2</sup> | 2.5               |
| Conductor size (IEC) - Rigid cable     |          |                 |                   |
|  | min      | mm <sup>2</sup> | 0.5               |
|  | Max      | mm <sup>2</sup> | 2.5               |
| Mechanical life                        |          | cycles          | 1x10 <sup>6</sup> |
| <b>UL technical data</b>               |          |                 |                   |
| Motor power for direct-on-line control |          |                 |                   |
| for three-phase motor                  |          |                 |                   |
|  | 240V     | HP              | 3                 |
| for single-phase motor                 |          |                 |                   |
|  | 240V     | HP              | 1                 |
| <b>Ambient conditions</b>              |          |                 |                   |
| Temperature                            |          |                 |                   |
| Operating temperature                  |          |                 |                   |
|  | min      | °C              | -25               |
|  | max      | °C              | +55               |
| Storage temperature                    |          |                 |                   |
|  | min      | °C              | -40               |
|  | max      | °C              | +70               |
| <b>Resistance &amp; Protection</b>     |          |                 |                   |
| Frontal IP degree                      |          |                 | IP40              |

Terminals IP degree

IP20

**Dimensions**

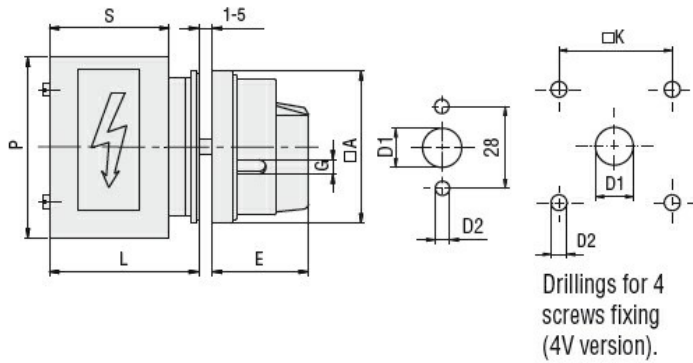

| Series      | Dimensions |    |    |      |   |    | L  |      |        |       |
|-------------|------------|----|----|------|---|----|----|------|--------|-------|
|             | □A         | D1 | D2 | E    | G | □K | 1  | 2    | 3...12 |       |
| <b>GF20</b> | 48         | 12 | 5  | 34.2 | 5 | 36 | 44 | 57.5 | 71     | 192.5 |

**Wiring diagrams**

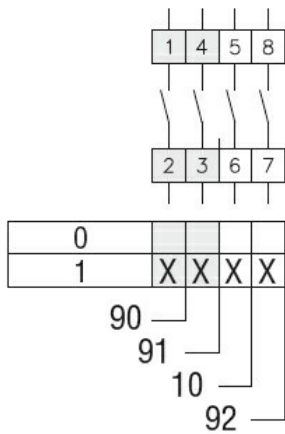

**Certifications and compliance**

Compliance

CSA C22.2 n° 14  
IEC/EN/BS 60947-1  
IEC/EN/BS 60947-3  
IEC/EN/BS 60947-5-1  
UL60947-4-1

Certificates

cULus  
EAC

**ETIM classification**

ETIM 8.0

EC001029 -  
Selector switch,  
complete