

|   |                    |     |      |                                     |
|---|--------------------|-----|------|-------------------------------------|
| Product designation                                       |                    |     |      | Rotary cam switches                 |
| Product type designation                                  |                    |     |      | GF20                                |
| <b>General characteristics</b>                            |                    |     |      |                                     |
| Switching diagram   |                    |     |      | 52 - Changeover switch 2 poles      |
| N° of elements  |                    |     |      | 2                                   |
| Mounting form   |                    |     |      | O - Rear mounting with black handle |
| <b>Contact characteristics</b>                            |                    |     |      |                                     |
| Rated insulation voltage $U_i$                            | IEC/EN             | V   | 480  |                                     |
|   | UL/CSA             | V   | 240  |                                     |
| Rated impulse withstand voltage $U_{imp}$                 |                    | kV  | 4    |                                     |
| Conventional free air thermal current $I_{th}$            | IEC/EN             | A   | 20   |                                     |
|   | UL/CSA             | A   | 15   |                                     |
| Rated operational voltage                                 |                    | V   | 480  |                                     |
| Rated operational impulse voltage                         |                    | kV  | 4    |                                     |
| Maximum fuse size for short-circuit protection $I_n$ (gG) | 10kA               | A   | 20   |                                     |
|   | 15kA               | A   | 20   |                                     |
|   | 25kA               | A   | 20   |                                     |
| Rated short time current $I_{cw}$                         |                    | 1s  | kA   | 250                                 |
|   |                    |     |      | 10/5 mA/V                           |
| Conductivity  |                    |     |      | 10/5 mA/V                           |
| Operational current $I_e$ IEC/EN                          | AC1/AC21A          |     |      | A 20                                |
|   | AC15               |     |      |                                     |
|   | 110V               | A   | 10   |                                     |
|   | 220/230V           | A   | 8    |                                     |
|   | 380/400V           | A   | 6    |                                     |
| Rated operational power in AC                             | Three-phase AC-3   |     |      |                                     |
|   | 220/230V           | kW  | 3    |                                     |
|   | 380/440V           | kW  | 5    |                                     |
|   | Single-phase AC-3  |     |      |                                     |
|   | 110V               | kW  | 0.5  |                                     |
|   | 220/230V           | kW  | 1.5  |                                     |
|   | 380/440V           | kW  | 2    |                                     |
|   | Three-phase AC23A  |     |      |                                     |
|   | 220/230V           | kW  | 4    |                                     |
|   | 380/440V           | kW  | 7.5  |                                     |
|   | Single-phase AC23A |     |      |                                     |
|   | 110V               | kW  | 0.75 |                                     |
| 220/230V  | kW                 | 2   |      |                                     |
| 380/440V  | kW                 | 2.5 |      |                                     |
| Rated operational current in DC                           | DC21A              |     |      |                                     |
|   | 48V                | A   | 20   |                                     |
|   | 60V                | A   | 20   |                                     |

|  |                                       |      |                 |                   |
|--|---------------------------------------|------|-----------------|-------------------|
|  |                                       | 110V | A               | 4                 |
|  |                                       | 220V | A               | 0.7               |
|  |                                       | 440V | A               | 0.2               |
| DC13                                   |                                       | 24V  | A               | 6                 |
|  |                                       | 48V  | A               | 6                 |
|  |                                       | 60V  | A               | 3                 |
|  |                                       | 110V | A               | 1                 |
|  |                                       | 220V | A               | 0.4               |
|  |                                       | 440V | A               | 0.15              |
| Power dissipation                      |                                       |      | W               | 0.8               |
| <b>Mechanical features</b>             |                                       |      |                 |                   |
| Terminals screw                        |                                       |      |                 | M3                |
| Tightening torque for terminals max    |                                       |      | Nm              | 0.5               |
| Conductor size                         |                                       |      |                 |                   |
|  | AWG - Rigid cable                     |      |                 |                   |
|  |                                       | min  | AWG             | 20                |
|  |                                       | Max  | AWG             | 12                |
|  | AWG - Flexible cable                  |      |                 |                   |
|  |                                       | min  | AWG             | 20                |
|  |                                       | Max  | AWG             | 12                |
|  | Conductor size (IEC) - Flexible cable |      |                 |                   |
|  |                                       | min  | mm <sup>2</sup> | 0.5               |
|  |                                       | Max  | mm <sup>2</sup> | 2.5               |
|  | Conductor size (IEC) - Rigid cable    |      |                 |                   |
|  |                                       | min  | mm <sup>2</sup> | 0.5               |
|  |                                       | Max  | mm <sup>2</sup> | 2.5               |
| Mechanical life                        |                                       |      | cycles          | 1x10 <sup>6</sup> |
| <b>UL technical data</b>               |                                       |      |                 |                   |
| Motor power for direct-on-line control |                                       |      |                 |                   |
|  | for three-phase motor                 |      |                 |                   |
|  |                                       | 240V | HP              | 3                 |
|  | for single-phase motor                |      |                 |                   |
|  |                                       | 240V | HP              | 1                 |
| <b>Ambient conditions</b>              |                                       |      |                 |                   |
| Temperature                            |                                       |      |                 |                   |
|  | Operating temperature                 |      |                 |                   |
|  |                                       | min  | °C              | -25               |
|  |                                       | max  | °C              | +55               |
|  | Storage temperature                   |      |                 |                   |
|  |                                       | min  | °C              | -40               |
|  |                                       | max  | °C              | +70               |
| <b>Resistance &amp; Protection</b>     |                                       |      |                 |                   |
| Frontal IP degree                      |                                       |      |                 | IP40              |
| Terminals IP degree                    |                                       |      |                 | IP20              |
| <b>Dimensions</b>                      |                                       |      |                 |                   |

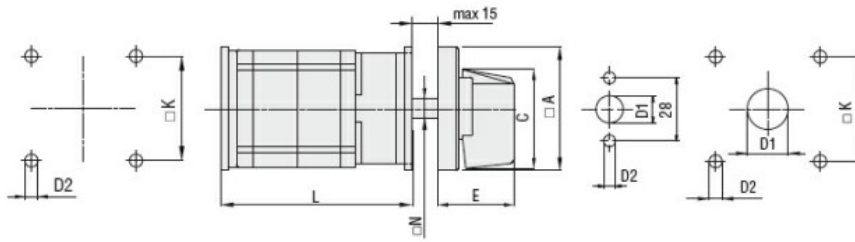

| Series | Dimensions |      |     |     |      |    |    | L Number of elements |      |    |      |     |       |     |       |     |       |     |       |
|--------|------------|------|-----|-----|------|----|----|----------------------|------|----|------|-----|-------|-----|-------|-----|-------|-----|-------|
|        | □A         | C    | ØD1 | ØD2 | E    | □K | N  | 1                    | 2    | 3  | 4    | 5   | 6     | 7   | 8     | 9   | 10    | 11  | 12    |
| GF20   | 48         | 39.5 | 12  | 5   | 26.5 | 36 | □6 | 46                   | 59.5 | 73 | 86.5 | 100 | 113.5 | 127 | 140.5 | 154 | 167.5 | 181 | 194.5 |

**Wiring diagrams**

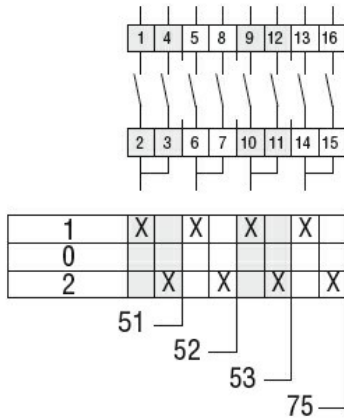

**Certifications and compliance**

**Compliance**

- CSA C22.2 n° 14
- IEC/EN/BS 60947-1
- IEC/EN/BS 60947-3
- IEC/EN/BS 60947-5-1
- UL60947-4-1

**Certificates**

- cULus
- EAC

**ETIM classification**

ETIM 8.0

EC001029 -  
Selector switch,  
complete