



|   |                                     |     |      |
|---|-------------------------------------|-----|------|
| Product designation                                       | Rotary cam switches                 |     |      |
| Product type designation                                  | 7GN40                               |     |      |
| <b>General characteristics</b>                            |                                     |     |      |
| Switching diagram   | 92 - ON/OFF switch 4 poles          |     |      |
| N° of elements  | 2                                   |     |      |
| Mounting form   | O - Rear mounting with black handle |     |      |
| <b>Contact characteristics</b>                            |                                     |     |      |
| Rated insulation voltage $U_i$                            | IEC/EN                              | V   | 690  |
|   | UL/CSA                              | V   | 600  |
| Rated impulse withstand voltage $U_{imp}$                 |                                     | kV  | 6    |
| Conventional free air thermal current $I_{th}$            | IEC/EN                              | A   | 40   |
|   | UL/CSA                              | A   | 50   |
| Rated operational voltage                                 |                                     | V   | 480  |
| Rated operational impulse voltage                         |                                     | kV  | 4    |
| Maximum fuse size for short-circuit protection $I_n$ (gG) | 10kA                                | A   | 40   |
|   | 15kA                                | A   | 40   |
|   | 25kA                                | A   | 40   |
|   | 50kA                                | A   | 40   |
|   | 63kA                                | A   | 40   |
| Rated short time current $I_{cw}$                         | 1s                                  | kA  | 1000 |
|   | Conductivity 10/5 mA/V              |     |      |
| Operational current $I_e$ IEC/EN                          | AC1/AC21A                           |     | A 40 |
|   | AC15                                |     |      |
| Rated operational power in AC                             | 110V                                | A   | 25   |
|   | 220/230V                            | A   | 22   |
|   | 380/400V                            | A   | 12   |
|   | 660/690V                            | A   | 2    |
|   | Three-phase AC-3                    |     |      |
| 220/230V  | kW                                  | 8   |      |
| 380/440V  | kW                                  | 15  |      |
| 500/690V  | kW                                  | 15  |      |
| Single-phase AC-3   |                                     |     |      |
| 110V  | kW                                  | 3   |      |
| 220/230V  | kW                                  | 6.5 |      |
| 380/440V  | kW                                  | 8   |      |

|  |          |                 |                   |
|--|----------|-----------------|-------------------|
| Three-phase AC23A                      |          |                 |                   |
|  | 220/230V | kW              | 8                 |
|  | 380/440V | kW              | 18.5              |
|  | 500/690V | kW              | 22                |
| Single-phase AC23A                     |          |                 |                   |
|  | 110V     | kW              | 3                 |
|  | 220/230V | kW              | 6                 |
|  | 380/440V | kW              | 11                |
| Rated operational current in DC        |          |                 |                   |
| DC21A                                  |          |                 |                   |
|  | 48V      | A               | 40                |
|  | 60V      | A               | 40                |
|  | 110V     | A               | 6                 |
|  | 220V     | A               | 0.9               |
| DC23A (poles in series)                |          |                 |                   |
|  | 24V      | A               | 40 (1)            |
|  | 48V      | A               | 40 (2)            |
|  | 60V      | A               | 40 (3)            |
|  | 110V     | A               | 20 (3)            |
|  | 220V     | A               | 12 (4)            |
| DC13                                   |          |                 |                   |
|  | 24V      | A               | 40                |
|  | 48V      | A               | 32                |
|  | 60V      | A               | 16                |
|  | 110V     | A               | 3                 |
| Power dissipation                      |          | W               | 2.0               |
| <b>Mechanical features</b>             |          |                 |                   |
| Terminals screw                        |          |                 | M4                |
| Tightening torque for terminals max    |          | Nm              | 1.2               |
| Conductor size                         |          |                 |                   |
| AWG - Rigid cable                      |          |                 |                   |
|  | min      | AWG             | 16                |
|  | Max      | AWG             | 8                 |
| AWG - Flexible cable                   |          |                 |                   |
|  | min      | AWG             | 16                |
|  | Max      | AWG             | 10                |
| Conductor size (IEC) - Flexible cable  |          |                 |                   |
|  | min      | mm <sup>2</sup> | 1.5               |
|  | Max      | mm <sup>2</sup> | 6                 |
| Conductor size (IEC) - Rigid cable     |          |                 |                   |
|  | min      | mm <sup>2</sup> | 1.5               |
|  | Max      | mm <sup>2</sup> | 10                |
| Mechanical life                        |          | cycles          | 5x10 <sup>6</sup> |
| <b>UL technical data</b>               |          |                 |                   |
| Motor power for direct-on-line control |          |                 |                   |
| for three-phase motor                  |          |                 |                   |
|  | 120V     | HP              | 5                 |
|  | 240V     | HP              | 10                |
|  | 480V     | HP              | 20                |
|  | 600V     | HP              | 20                |
| for single-phase motor                 |          |                 |                   |
|  | 120V     | HP              | 2                 |
|  | 240V     | HP              | 5                 |
| <b>Ambient conditions</b>              |          |                 |                   |

Temperature

Operating temperature

|     |    |     |
|-----|----|-----|
| min | °C | -25 |
| max | °C | +55 |

Storage temperature

|     |    |     |
|-----|----|-----|
| min | °C | -40 |
| max | °C | +70 |

Resistance & Protection

Frontal IP degree IP40

Terminals IP degree IP00

Dimensions

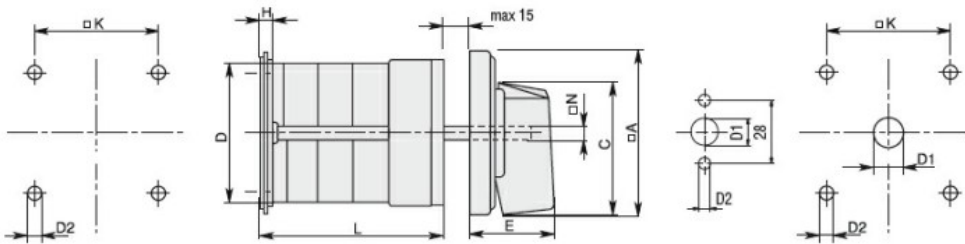

| Series | Dimensions |      |    |     |      |     |    |    | L Number of elements |       |      |       |       |       |       |       |       |       |       |       |
|--------|------------|------|----|-----|------|-----|----|----|----------------------|-------|------|-------|-------|-------|-------|-------|-------|-------|-------|-------|
|        | □A         | C    | ØD | ØD2 | E    | H   | □K | □N | 1                    | 2     | 3    | 4     | 5     | 6     | 7     | 8     | 9     | 10    | 11    | 12    |
| 7GN12  | 48         | 39.5 | 39 | 5   | 26.5 | 5   | 36 | 6  | 38.1                 | 47.8  | 57.5 | 67.2  | 76.9  | 86.6  | 96.3  | 106   | 115.7 | 125.4 | 135.1 | 144.8 |
| 7GN20  | 48         | 39.5 | 39 | 5   | 26.5 | 5   | 36 | 6  | 38.1                 | 47.8  | 57.5 | 67.2  | 76.9  | 86.6  | 96.3  | 106   | 115.7 | 125.4 | 135.1 | 144.8 |
| 7GN25  | 48         | 39.5 | 43 | 5   | 26.5 | 5   | 36 | 6  | 42.5                 | 56.1  | 69.7 | 83.3  | 96.9  | 110.5 | 124.1 | 137.7 | 151.3 | 164.9 | 178.5 | 192.1 |
| 7GN32  | 65         | 53   | 58 | 5   | 34.5 | 5.5 | 48 | 7  | 48.5                 | 63.6  | 78.7 | 93.8  | 108.9 | 124   | 139.1 | 154.2 | 169.3 | 184.4 | 199.5 | 214.6 |
| 7GN40  | 65         | 53   | 58 | 5   | 34.5 | 5.5 | 48 | 7  | 48.5                 | 63.6  | 78.7 | 93.8  | 108.9 | 124   | 139.1 | 154.2 | 169.3 | 184.4 | 199.5 | 214.6 |
| 7GN63  | 65         | 53   | 62 | 6   | 34.5 | 7.5 | 68 | 7  | 53.3                 | 71.4  | 89.5 | 107.6 | 125.7 | 143.8 | 161.9 | 180   | 198.1 | 216.2 | 234.3 | 252.4 |
| 7GN125 | 90         | 70.5 | 86 | 6   | 41.4 | 7.5 | 68 | 9  | 74.8                 | 103.9 | 133  | 162.1 | 191.2 | 220.3 | 249.4 | 278.5 | 307.6 | 336.7 | 365.8 | 394.9 |

Wiring diagrams

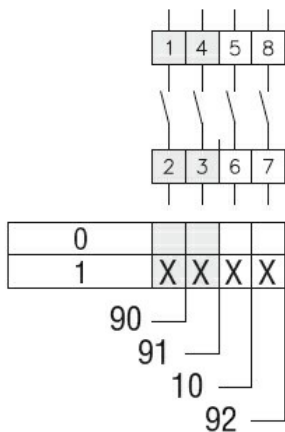

Certifications and compliance

Compliance

- CSA C22.2 n° 14
- IEC/EN/BS 60947-1
- IEC/EN/BS 60947-3
- IEC/EN/BS 60947-5-1
- UL60947-4-1

Certificates

cCSAus

---

EAC

---

UL

ETIM classification

ETIM 8.0

EC001029 -  
Selector switch,  
complete