

Product designation				Rotary cam switches		
Product type designation				7GN12		
<b>General characteristics</b>						
Switching diagram				109 - Multi-step 0-1-2-3-4 1 pole		
N° of elements				2		
Mounting form				U47 - Snap on front mounting with black handle for hole diam. 22mm fixing		
<b>Contact characteristics</b>						
Rated insulation voltage $U_i$	IEC/EN	V	690			
	UL/CSA	V	600			
Rated impulse withstand voltage $U_{imp}$		kV	6			
Conventional free air thermal current $I_{th}$	IEC/EN	A	16			
	UL/CSA	A	15			
Rated operational voltage		V	480			
Rated operational impulse voltage		kV	4			
Maximum fuse size for short-circuit protection $I_n$ (gG)	10kA	A	16			
	15kA	A	10			
	25kA	A	10			
Rated short time current $I_{cw}$		1s	kA	200		
				10/5 mA/V		
Conductivity				10/5 mA/V		
Operational current $I_e$ IEC/EN	AC1/AC21A			A		
	AC15					
Rated operational power in AC	Three-phase AC-3			110V	A	10
				220/230V	A	8
				380/400V	A	4
				660/690V	A	1.5
	Single-phase AC-3			110V	kW	0.8
				220/230V	kW	1.5
				380/440V	kW	2.2
	Three-phase AC23A			220/230V	kW	3
				380/440V	kW	5.5
				500/690V	kW	7.5
Single-phase AC23A			110V	kW	0.8	
			220/230V	kW	1.7	
			380/440V	kW	3	

Rated operational current in DC			
DC21A			
	48V	A	12
	60V	A	12
	110V	A	4
	220V	A	0.6
	440V	A	0.25
DC23A (poles in series)			
	24V	A	10 (1)
	48V	A	10 (2)
	60V	A	10 (3)
	110V	A	5 (3)
	220V	A	5 (4)
DC13			
	24V	A	12
	48V	A	10
	60V	A	8
	110V	A	1
	220V	A	0.4
	440V	A	0.15
Power dissipation		W	0.8
<b>Mechanical features</b>			
Terminals screw			M3
Tightening torque for terminals max		Nm	0.5
Conductor size			
AWG - Rigid cable			
	min	AWG	20
	Max	AWG	12
AWG - Flexible cable			
	min	AWG	20
	Max	AWG	14
Conductor size (IEC) - Flexible cable			
	min	mm <sup>2</sup>	0.5
	Max	mm <sup>2</sup>	2.5
Conductor size (IEC) - Rigid cable			
	min	mm <sup>2</sup>	0.5
	Max	mm <sup>2</sup>	2.5
Mechanical life		cycles	3x10 <sup>6</sup>
<b>UL technical data</b>			
Motor power for direct-on-line control			
for three-phase motor			
	120V	HP	1.5
	240V	HP	3
for single-phase motor			
	120V	HP	0.5
	240V	HP	1
<b>Ambient conditions</b>			
Temperature			
Operating temperature			
	min	°C	-25
	max	°C	+55
Storage temperature			
	min	°C	-40
	max	°C	+70

**Resistance & Protection**

Frontal IP degree	IP40
Terminals IP degree	IP00

**Dimensions**

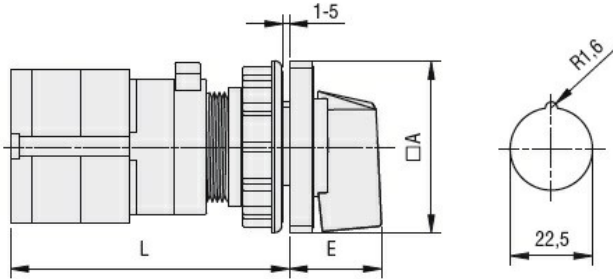

Series	Dimensions		L			
	□A	E	1	2	3...8	
7GN12	48	26.5	58	67.7	77.4	125.9
7GN20	48	26.5	58	67.7	77.4	125.9
7GN25	48	26.5	62.4	76	89.6	157.6

**Wiring diagrams**

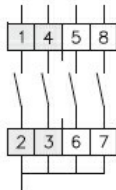

0				
1	X			
2			X	
3		X		
4				X

109

**Certifications and compliance**

**Compliance**

CSA C22.2 n° 14  
IEC/EN/BS 60947-1  
IEC/EN/BS 60947-3  
IEC/EN/BS 60947-5-1  
UL60947-4-1

**Certificates**

cCSAus  
EAC  
UL

**ETIM classification**

**ETIM 8.0**

EC001029 -  
Selector switch,  
complete