



Top push rod  
plunger  
KCA

Product designation

Product type designation

**General characteristics**

Material

|         |                          |
|---------|--------------------------|
| Housing | Polymer<br>thermoplastic |
| Rod     | Aluminium-zinc<br>alloy  |

**Contact characteristics**

|   |                 |                        |     |
|---|-----------------|------------------------|-----|
| Type of contact   | 2NC Slow action |                        |     |
| Thermal current I <sub>th</sub>                           | A               | 10                     |     |
| IEC/EN 60947-5-1 designation                              | A600 Q600       |                        |     |
| Rated insulation voltage U <sub>i</sub>                   | V               | 690                    |     |
| Rated impulse withstand voltage U <sub>imp</sub>          | kV              | 6                      |     |
| Insulation class  | II              |                        |     |
| Short-circuit protection with fuse                        | Class/A         | 10 gG/SC<br>QUICK FUSE |     |
| Switching speed   | min             | m/s                    | 0.5 |
|   | max             | m/s                    | 1.5 |
| IEC Conventional free air thermal current I <sub>th</sub> | A               | 10                     |     |
| Resistance per pole (average value)                       | mΩ              | <10                    |     |

**Mechanical features**

|                         |                           |                 |       |
|-------------------------|---------------------------|-----------------|-------|
| Operating head fixing   | Locking bayonet<br>insert |                 |       |
| Operating torque        | N                         | 5               |       |
|                         | lb                        | 1.1             |       |
| Tightening torque (Max) |                           |                 |       |
| Switch fixing           | Nm                        | 2.5             |       |
|                         | lbin                      | 22.1            |       |
| Contact terminals       | Nm                        | 0.8             |       |
|                         | lbin                      | 7               |       |
| Body lid screw fixing   | Nm                        | 0.8             |       |
|                         | lbin                      | 7               |       |
| Conductor section       |                           |                 |       |
| AWG/Kcmil               | min                       | 16              |       |
|                         | max                       | 14              |       |
| IEC                     | min                       | mm <sup>2</sup> | 1or 2 |
|                         | max                       | mm <sup>2</sup> | 2.5   |

|                  |                               |
|------------------|-------------------------------|
| Cable connection | Self-releasing screw terminal |
| Cable entry      | M20 on the sides              |

**Operations**

|                      |          |           |
|----------------------|----------|-----------|
| Mechanical life      | cycles   | <10000000 |
| Mechanical operation | cycles/h | 3600      |

**Ambient conditions**

|             |                       |     |    |     |
|-------------|-----------------------|-----|----|-----|
| Temperature | Operating temperature | min | °C | -25 |
|             |                       | max | °C | +70 |
|             | Storage temperature   | min | °C | -40 |
|             |                       | max | °C | +70 |

**Resistance & Protection**

|                  |              |      |
|------------------|--------------|------|
| IP degree        | Terminals    | IP20 |
|                  | Body housing | IP65 |
| Pollution degree |              | 3    |

**Dimensions**

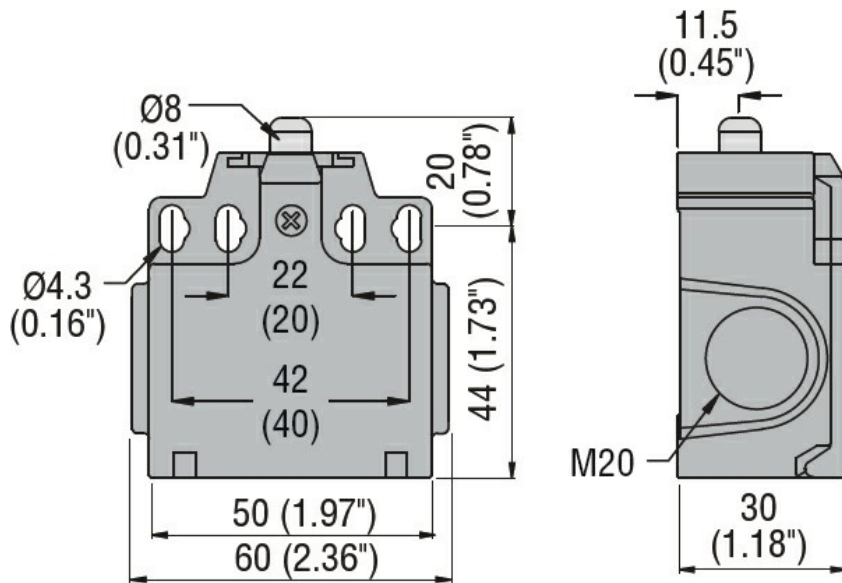

**Wiring diagrams**

## Slow action



### Certifications and compliance

#### Compliance

CSA C22.2 n° 14  
EN 50047  
IEC/EN 60204-1  
IEC/EN 60947-1  
IEC/EN 60947-5-1  
UL508

#### Certificates

CCC  
cULus  
EAC

### ETIM classification

ETIM 8.0

EC000030 - End  
switch