

FUSIBLE DISCONNECT SWITCHES (UL98)



Three-pole fusible disconnect switches (UL98)



GEF0030JUL



GEF0060JUL



GEF0100JUL - GEF0200JUL

Order code	General purpose current	UL fuse type	Command pole position	Qty per pkg	Wt
	[A]	[A]		n°	[kg]

Supplied without handle.
Complete the disconnect switches by selecting shaft extension and handle for door coupling version or the handle for direct operating version.

GEF0030JUL	30	J	Left	1	1.500
GEF0060JUL	60	J	Left	1	1.880
GEF0100JUL	100	J	Left	1	4.000
GEF0200JUL	200	J	Left	1	4.000

UL/CSA ratings

Type	3 phase [HP]			Short-circuit rating at 600VAC	Fuse type	
	240V	480V	600V		[kA]	[A] [class]
GEF0030JUL	7.5	15	20	200	30 J	
GEF0060JUL	15	30	50	200	60 J	
GEF0100JUL	30	60	75	200	100 J	
GEF0200JUL	50	100	125	200	200 J	

General characteristics

- General purpose current according to UL98: 30A to 200A
- Available versions: direct operating and door coupling
- Screw
- Possibility to adjust the position of the clips for screw fixing on plate.

Operational characteristics

- IEC rated insulation voltage U_i : 1000V
- UL max operating voltage: 600V
- IEC rated impulse withstand voltage U_{imp} : 3kV for GEF0030JUL and GEF0060JUL, 12kV for GEF0100JUL and GEF0200JUL
- Mechanical life:
 - 10,000 cycles for GEF0030JUL and GEF0060JUL
 - 8,000 cycles for GEF0100JUL and GEF0200JUL

Certifications and compliance

Certifications obtained: cULus according to UL98 / CSA C22.2 n°4.
Compliant with standards: IEC/EN/BS 60947-3, IEC/EN/BS 60947-1.

Add-on blocks and accessories



GEFX10...



GEFX10S...



GEFX8...

Order code	Description	Qty per pkg	Wt
		n°	[kg]

Auxiliary contacts

GEFX1011	1NO/1NC changeover	1	0.032
----------	--------------------	---	-------

Auxiliary contacts mounting support

GEFX10S1	For simultaneous closing. For GEF0030JUL, GEF0060JUL	1	0.080
GEFX10SEA1	For early-make contact operation, to be only used for 2NO/2NC configuration. For GEF0030JUL, GEF0060JUL	1	0.080
GEFX10S2	For simultaneous closing. For GEF0100JUL, GEF0200JUL	1	0.100
GEFX10SEA2	For early-make contact operation, to be only used for 2NO/2NC configuration. For GEF0100JUL, GEF0200JUL	1	0.100

Set of terminal covers. Snap-on fixing.

GEFX800UL	3-piece set, each covers one pole. For GEF0060JUL	1	0.900
GEFX802	3-piece set, each covers one pole. For GEF0100JUL, GEF0200JUL	1	0.120

Terminal lug.

GEFX500	For GEF0060JUL	1	0.049
GEFX501	For GEF0100JUL, GEF0200JUL	1	0.100

General characteristics for auxiliary contacts

IEC conventional free air thermal current I_{th} : 16A.

Certifications and compliance

Certifications obtained: cULus according to UL98 / CSA C22.2 n°4.
Compliant with standards: IEC/EN/BS 60947-3, IEC/EN/BS 60947-1.

Handles and shaft extensions



GEFX6...DB



GEFX61



GEFX7...GEFX7...

Order code	Characteristics	Qty per pkg	Wt
		n°	[kg]

DIRECT OPERATING LEVER HANDLE, PADLOCKABLE.
Rotating type with screw fixing on disconnect switches.

GEFX61DB	50mm/2" black lever. For GEF0030JUL, GEF0060JUL	1	0.055
GEFX62DB	65mm/2.6" black lever. For GEF0100JUL, GEF0200JUL	1	0.075

DOOR COUPLING LEVER HANDLE, PADLOCKABLE.
Red/yellow rotating type with screw fixing on door.
Shaft extension to order separately.

GEFX61	94mm/3.7". □7mm/0.3". IP65. For GEF0030JUL, GEF0060JUL	1	0.302
GEFX62	115mm/4.5". □10mm/0.4". IP65. For GEF0100JUL, GEF0200JUL	1	0.312

DOOR COUPLING LEVER HANDLE, PADLOCKABLE.
Black rotating type with screw fixing on door.
Shaft extension to order separately.

GEFX61B	94mm/3.7". □7mm/0.3". IP65. For GEF0030JUL, GEF0060JUL	1	0.302
GEFX62B	115mm/4.5". □10mm/0.4". IP65. For GEF0100JUL, GEF0200JUL	1	0.312

SHAFT EXTENSIONS for door coupling handles.
For GEF0030JUL, GEF0060JUL.

GEFX7177	177mm/7", □7mm/0.3"	1	0.077
GEFX7250	250mm/9.8", □7mm/0.3"	1	0.084
GEFX7387	387mm/15.2", □7mm/0.3"	1	0.142

For GEF0100JUL, GEF0200JUL.

GEFX7227	227mm/8.9", □10mm/0.4"	1	0.184
GEFX7375	375mm/14.8", □10mm/0.4"	1	0.274
GEFX7536	536mm/21.1", □10mm/0.4"	1	0.408

Form and handle length	Handle types
50mm/2"	GEFX61DB
65mm/2.6"	GEFX62DB
94mm/3.7"	GEFX61 - GEFX61B
115mm/4.5"	GEFX62 - GEFX62B

Certifications and compliance

Certification obtained: cULus according to UL98A/GSA C22.2 n°4.
Compliant with standards: IEC/EN/BS 60947-1, IEC/EN/BS 60947-3.

Technical characteristics

TYPE	3-pole	GEF030JUL	GEF060JUL	GEF0100JUL	GEF0200JUL
CONTACT CHARACTERISTICS					
IEC conventional free air thermal current I _{th} (≤40°C)	A	30	60	100	200
IEC rated insulation voltage U _i	V	1000			
IEC rated impulse withstand voltage U _{imp}	kV	8		12	
Compliance		UL98			
General purpose rating (≤40°C)	A	30	60	100	200
Max operating voltage U _i	V	600			
Horsepower ratings/ motor FLA current three-phase	240V	HP/A	15/42	30/80	50/130
	480V	HP/A	30/40	60/77	100/124
	600V	HP/A	50/52	75/77	125/125
Short circuit ratings	KA rms	200			
With fuse	class/A	30/J 21x57	60J 27x60	100/J 29x117	200J 41x146
Mechanical life	cycles	10,000			
Conductor section min... max	AWG	10-2	6-2/0	3-300kcmil	3/0-300/kcmil
Conductor tightening torque	Nm	2	6	18	18
	lb.in	17.7	53	159	159
Terminal lug kits		Built-in	GEFX500	GEFX501	
Terminal lugs tightening torque	Nm	-	13.5	31	
	lb.in	-	120	275	
AMBIENT CONDITIONS					
Temperature	Operating	°C	-25...+55		
	Storage	°C	-40...+70		
Maximum altitude	m	3000			
Fixing		Screw			

Dimensions [mm(in)]

GEF0030JUL

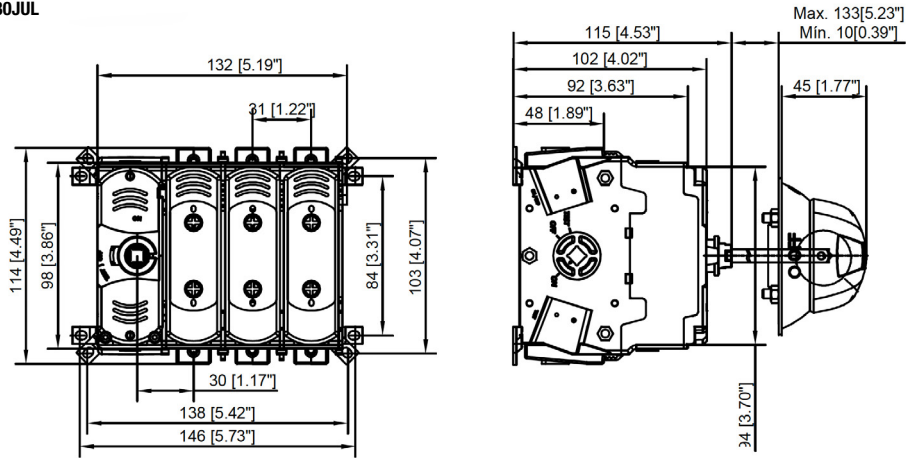

GEF0060JUL

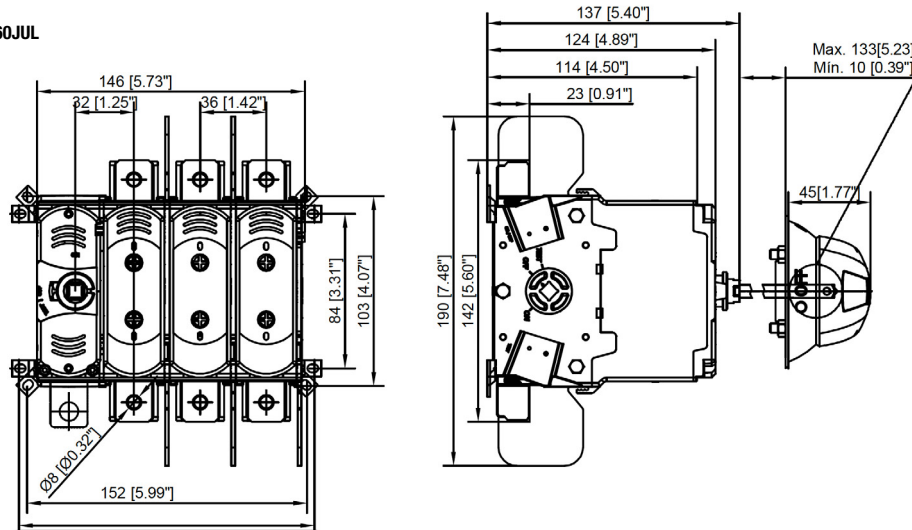

GEF0100JUL...GEF0200JUL

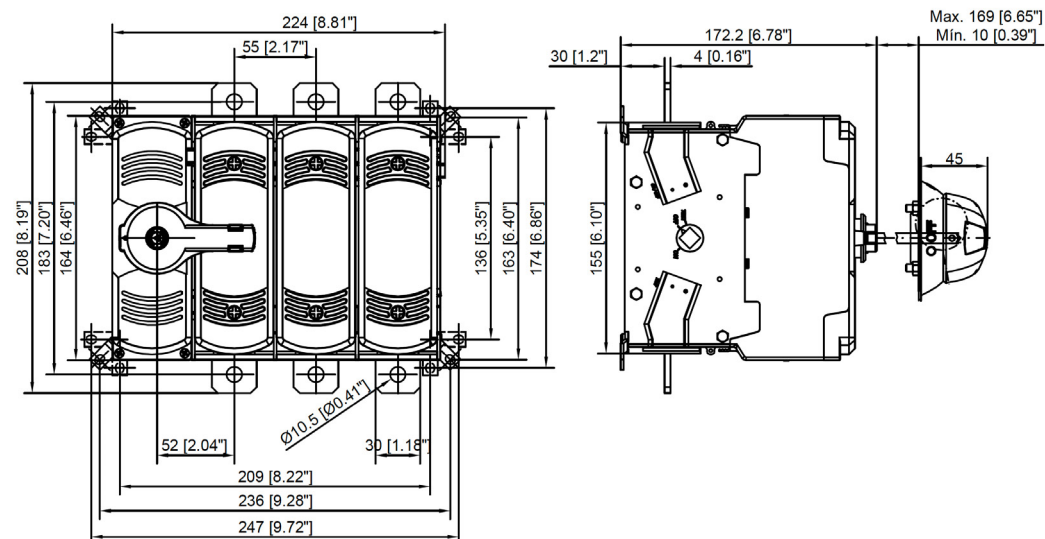



FUSIBLE DISCONNECT SWITCHES UL98



ENERGY AND AUTOMATION

LOVATO ELECTRIC S.P. A.

via Don E. Mazza, 12
24020 Gorle (Bergamo) ITALY
tel +39 035 4282111

www.LovatoElectric.com



The products described in this document are subject to update and modification at any time. The descriptions, technical and functional information, illustrations and instructions in the leaflet are to be considered as purely illustrative and consequently have no contractual relevance. Remember also that the products themselves must be used by qualified personnel in compliance with current plant engineering and installation standards, in order to avoid injury to persons or damage to property.