



Product designation

Product type designation

Type of CT

Current
trasformers
Current
trasformers
Solid-core for
busbars

Current inputs

| | | |
|-------------------------------|------------------|----------------------|
| Primary current I_{pn} (/5) | A | 400 |
| Operational frequency | min max | Hz Hz 50 60 |
| Secondary output current | A | 5 |
| Overload withstand I_{pn} | % | 100 |
| Burden | cl. 0.5 cl. 1 | VA VA 10 12 |

Insulations

| | | |
|---|----------------|---------|
| Rated insulation voltage U_i IEC/EN | V | 720 |
| IEC rated short-time thermal current I_{th} | I_{th} for s | 40...60 |
| IEC rated dynamic current I_{dyn} | I_{th} for s | 2.5 |
| Insulation dry type | | Class E |

Mechanical features

| | | |
|----------------|---|-------------------------|
| Terminals type | | Screw |
| Fixing | | DIN rail or by Screw |
| Weight | g | 307 |

Ambient conditions

| | | | |
|-------------------|-----------------------|------------|------------------------|
| Temperature | Operating temperature | min max | °C °C -25 +50 |
| | Storage temperature | min max | °C °C -40 +80 |
| Relative humidity | | % | 90 |
| Protection degree | | | IP20 |

Dimensions

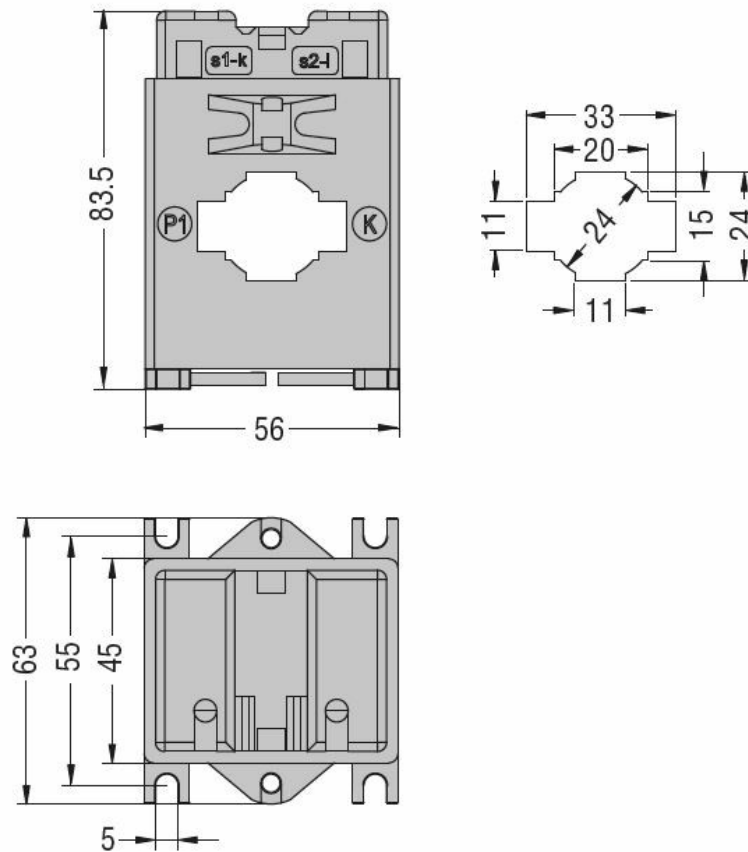

Certifications and compliance

Certifications

IEC/EN/BS 61869-1

IEC/EN/BS 61869-2

Compliance

EAC

ETIM classification

EC000066 - Power contactor, AC switching